

REFLECTIONS NEWSLETTER

BSEC Special Edition



Reynaers for innovation and education

By Justin Hunter, Managing Director, Reynaers UK

In last October's Newsletter I wrote that Reynaers will maintain a high level of investment in Innovation so that along with our customers, we will continue to flourish and prosper despite difficult market conditions. Consequently, in line with our ambitions, I am delighted to report that the bulk of the content in this Newsletter is devoted to the fruits of that continued

continued growth and ultimately will help us and our partners to buck the current recessionary trends. Therefore, during the first half of 2009 we will be launching some really dynamic new products such as Optima, Eco 75 and Reynapro. These developments will offer significant opportunities to win more business and improve, or at the very least protect, existing profit margins.

These developments will offer significant opportunities to win more business and improve, or at the very least protect, existing profit margins.

investment in Innovation. Probably more than ever before, during 2009 we will be announcing positive developments and dynamic initiatives which will secure

In a further statement of intent, we will soon be announcing the opening of our new Training School, here in Birmingham. This facility will be dedicated to improving the education of our employees, our customers and our



Justin Hunter

partners. In difficult times, improving the intellectual capital of our most valuable resources, our people, is more important than ever and will undoubtedly bring significant benefits.

Public sector specialists



Paul Gooch

Reynaers has a wealth of experience in public sector projects ranging from the NHS to social housing developments and, of course, the Building Schools for the Future programme.

In fact, such is the extent of our public sector work that we have recently appointed a dedicated Business Development Manager, Paul Gooch, who has responsibility for the many opportunities in this area.

"We understand the demands of the public sector" says Paul. "On the one hand there is a need to meet stringent standards in terms of health, safety and product quality, but this needs to be balanced against strict budget constraints.

Our products are manufactured to the highest standards and can meet all these demands - as our many successful public sector projects demonstrate. We're keen to show visitors to BSEC why, whether it's a new build or a school refurbishment, they should be specifying Reynaers".

You'll find Paul and his team on stand 657.



BSEC⁰⁹
THE BUILDING SCHOOLS
EXHIBITION & CONFERENCE
11 - 12 FEBRUARY MANCHESTER CENTRAL

See us on Stand 657

In this issue

- New products for 2009
- Why Reynaers is the green choice
- Reynaers project gets the Royal seal of approval

Royal opening for school's new facilities



'Barn' style design for rural surroundings



A number of Reynaers products were used in the recent construction of a new accommodation block and classroom at Brymore School of Rural Technology, an independent boarding school near Bridgewater. Architects, Stride Treglown, designed the new facilities paying careful attention to the nature and location of the site, the existing school buildings and the school's overall teaching culture.

The new facilities were officially opened by Her Royal Highness, The Princess Royal on January 19th this year.

As the surrounding buildings form part of the farming and horticultural operations of the school, the barn-like design of the new buildings - timber clad with profiled metal roofs - reflects this. Reynaers Vision 50 non-thermally insulated profiles, designed specifically for ground floor treatments, are used on both new buildings as is Reynaers Eco system for windows and doors. The accommodation block, which comprises 2,150 square metres of residential facilities for 100 students, also incorporates Reynaers CW50 curtain walling system.

Project Information.

Architect: HBS Architecture and Stride Treglown
Location: Cannington

Main contractor: RG Spiller Ltd

Fabricator: Total Aluminium
Reynaers Systems: Vision 50, CW50, Eco

Business school qualifies for campus renovation



Extensive refurbishment at world famous INSEAD

Almost 50 years after the INSEAD management school was established in Fontainebleau, France, the heart of its impressive campus has been renovated by the architects, Lehoux and Phily. The project has included the rebuilding of the very first INSEAD building, the Tour - Galerie.

The renovation work began by dismantling the old curtain walls of the building and replacing it with Reynaers CW86 EF curtain walling, as the architects felt that this type of non-bearing glass façade best satisfied the construction specifications with regard to the 2,800 square metres of surface area.

There were aesthetic considerations too - as all CW86 EF rails and struts have a constant visible thickness of 86mm and the panels have a uniform appearance inside and out. Another key consideration was that this system could be attached to the building quickly, since the large glass elements had already been fully finished in the factory, which meant the building would be exposed to the elements for the minimum time possible.

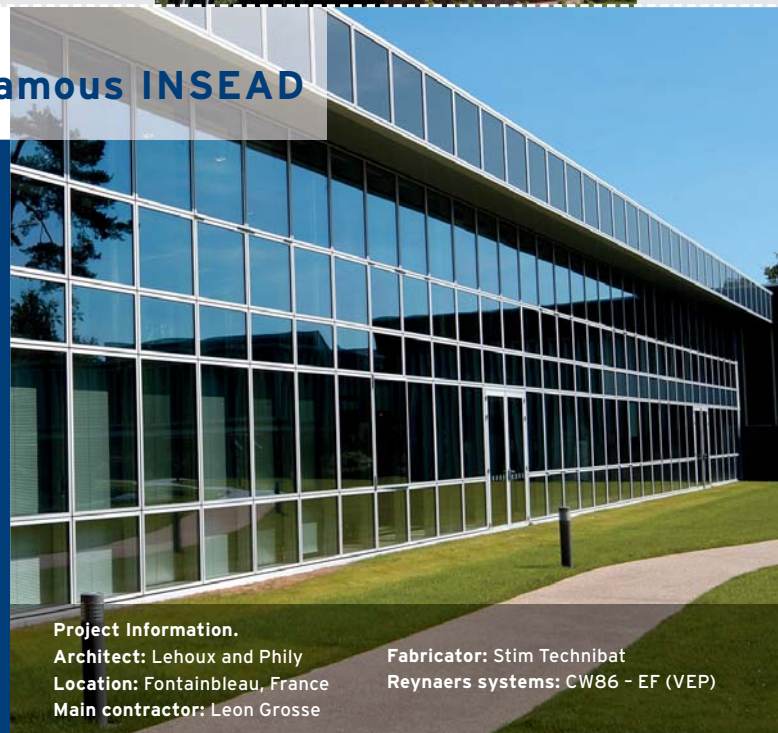

Project Information.

Architect: Lehoux and Phily
Location: Fontainebleau, France
Main contractor: Leon Grosse

Fabricator: Stim Technibat
Reynaers systems: CW86 - EF (VEP)

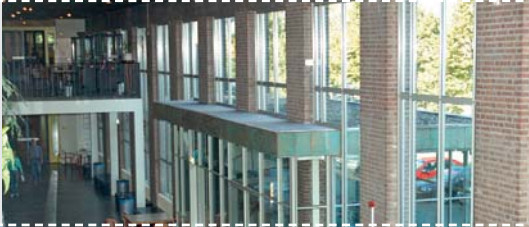

Sixties school is brought right up-to-date

Reynaers system permits sympathetic refurbishment



Reynaers played a key part in the refurbishment of St Jans School at Hertogenbosch in the Netherlands. The original building was a classic piece of 1960s architecture which no longer met with contemporary educational requirements and the architects' brief was to adapt and enhance it to bring it up-to-date.

To do so they specified Reynaers CS24 SL system throughout. This new three-chamber slimline casement window system has replaced the existing steel frame windows, thereby improving the thermal efficiency of the building while maintaining its traditional appearance.

Project Information.

Architect: Routhuizen, Van Doorn't Architecten
Location: The Netherlands

Fabricator: Elementz
Reynaers Systems: CS24 SL



Heathfield pupils benefit from brand new school

Winning design and build bid results in striking design for secondary school

Boon Brown Architects of Yeovil specified Reynaers throughout when they won the tender to design and build a new school at Monkton Heathfield on behalf of Somerset County Council.

The completed development replaces former prefabricated classrooms and provides 12 new standalone classrooms, all with associated staff rooms and support facilities, plus a substantial entrance foyer and exhibition space.

The contemporary light and airy design of the building utilises Reynaers Vision 50 insulated profiles at ground floor level throughout. The science laboratory features Reynaers Eco system windows and doors while the classrooms incorporate Reynaers CW50 curtain walling as well as Reynaers' windows and doors system, which boasts excellent insulation properties.



Project Information.

Architect: Boon Brown Architects
Location: Taunton
Main contractor: Dean & Dyball, Rok

Fabricator: Total Aluminium
Reynaers Systems: CW50, Vision 50, Eco

Parallel opening windows provide better air circulation



Providing optimal ventilation, the innovative parallel opening window system can be operated automatically, manually or via the Building Management system. Automatic operation takes into account internal factors such as general climate, as well as external factors such as outside temperature. In the event of a fire the windows can open automatically allowing smoke evacuation.

Particularly suitable for school environments, the parallel opening system has the advantage of providing the best possible ventilation for staff and pupils at all times, by allowing air flow around the outer window perimeter. Furthermore there is the added benefit of improved safety due to a reduction in the actual opening.

The parallel hinge also enables the façade to have smooth sight lines, giving obvious aesthetic benefits.

Eco 75 ideal choice for refurbishment projects

A new addition to Reynaers' popular Eco system for windows and doors is Eco 75. Compatible with all the existing Eco profiles and accessories, Eco 75 is suitable for the refurbishment of both timber and UPVC

frames. Its 75mm deep outer frames make it particularly suitable for school buildings and other public sector projects.

Available in a range of glass thicknesses, frame types and colours, Eco 75 boasts a superior thermal performance to steel and concrete as well as providing a cost effective solution. And its sleek sight lines are very much in keeping with conventional buildings which means refurbished buildings will show little or no difference in appearance.

Best selling product to be available as a fire resistant option

The introduction of a fire resistant option to Reynaers' popular CS77 thermally improved three-chamber system creates a unique and truly outstanding product. The system already boasts the optimum combination of safety and comfort as well as superior wind and water tightness. Now the fire resistant option, with its 60 minute window of escape, provides a better alternative to steel screens and makes the system even more suitable for school applications.

For further details of this and the other products mentioned on this page, visit Reynaers on stand 657.

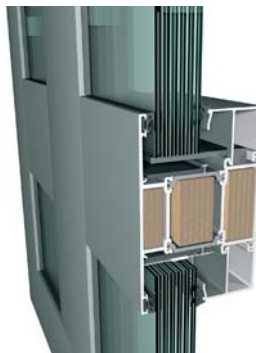

How we help meet green targets

Whilst Reynaers have seen significant growth in demand for aluminium systems from the public sector over the last few years we also fully understand the pressures that are now being placed on this sector and the implications they have on main contractors and fabricators. Consistently they are tasked to provide detailed analysis of the materials being used on site and their recyclability.

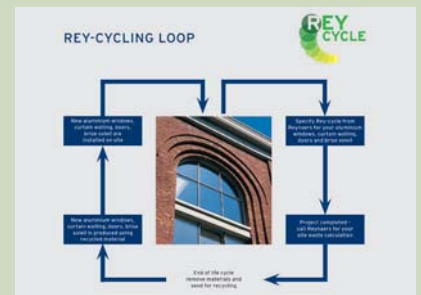

In response to this Reynaers has developed an all-encompassing recycling system specifically for the use of our customers.

Rey-cycle eases the burden on customers by providing all the necessary information, paperwork and calculations to complete a ready-prepared Site Waste Management Plan (SWMP).

This means that all our customers receive a full recycling management plan while customers can be confident that the maximum level of recycling possible is achieved, along with all the necessary documentation.

The **Rey-cycle** system even includes a Site Waste Calculator, which allows an accurate assessment to be made of the waste being removed from a site. This is particularly beneficial in the public sector because it allows a full inventory of waste to be created prior to the tender stage, which can then be tracked throughout a project in order to meet government targets.

For full details of the scheme visit www.reycycle.co.uk

Contact Info:

Head Office, Birmingham
Reynaers Ltd
Kettles Wood Drive, Birmingham B32 3DB
Tel: 0121 421 1999 Fax: 0121 421 9797
reynaersltd@reynaers.com

Reynaers Consult
Suite 9, The Arena, Stockley Park,
Uxbridge UB11 1AA
Tel: 0208 899 1741 Fax: 0208 899 1742
reynaers.consult.ltd@reynaers.com